

PARTS INCLUDED

- 1 x Light Unit with Bezel
- 3 x Screws
- Misc. Protective Material

INSTALLATION - WIRING

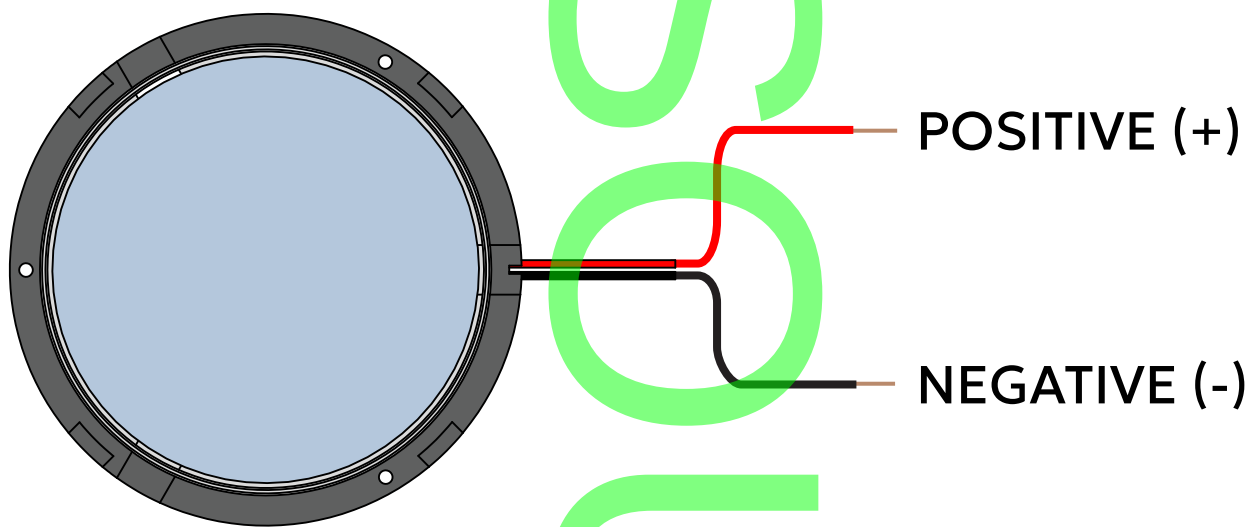

INSTALLATION - MOUNTING

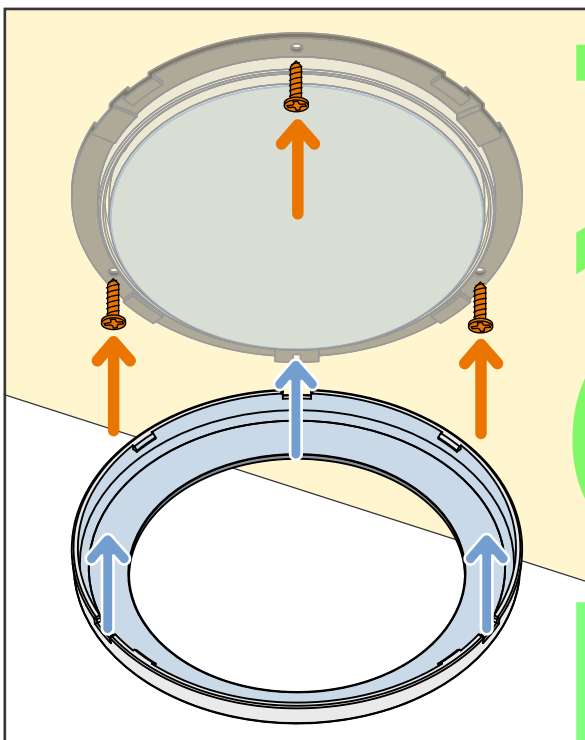

- **Test the Light Unit before installing.**
- Ensure flat surface for installation.
- Use the **Screws** to fix the Light Unit in place.
- Press in the **Bezel**.

WARNING

- To use the lights properly, please closely observe the instructions found in the manual. **The manufacturer shall not be liable for any damage or injuries resulting from misuse.**
- **Keep children away from electrical equipment.** Make sure the children are under supervision when operating.
- **Use the appropriate power supply and install correct sized-fuses for protection.** Over-voltage can cause irreversible circuitry damage and even fires.
- **Do not cover the lights with flammable material.**
- **Do not clean the lights with harsh detergents.** The light is not guaranteed protection against chemicals other than water.



MADE IN CHINA